

Industrial  
Hydraulics

Electric Drives  
and Controls

Linear Motion and  
Assembly Technologies

Pneumatics

Service  
Automation

Mobile  
Hydraulics

**Rexroth**  
Bosch Group

# GreenLight™ Program Next Day Linear Motion Components

The Drive & Control Company

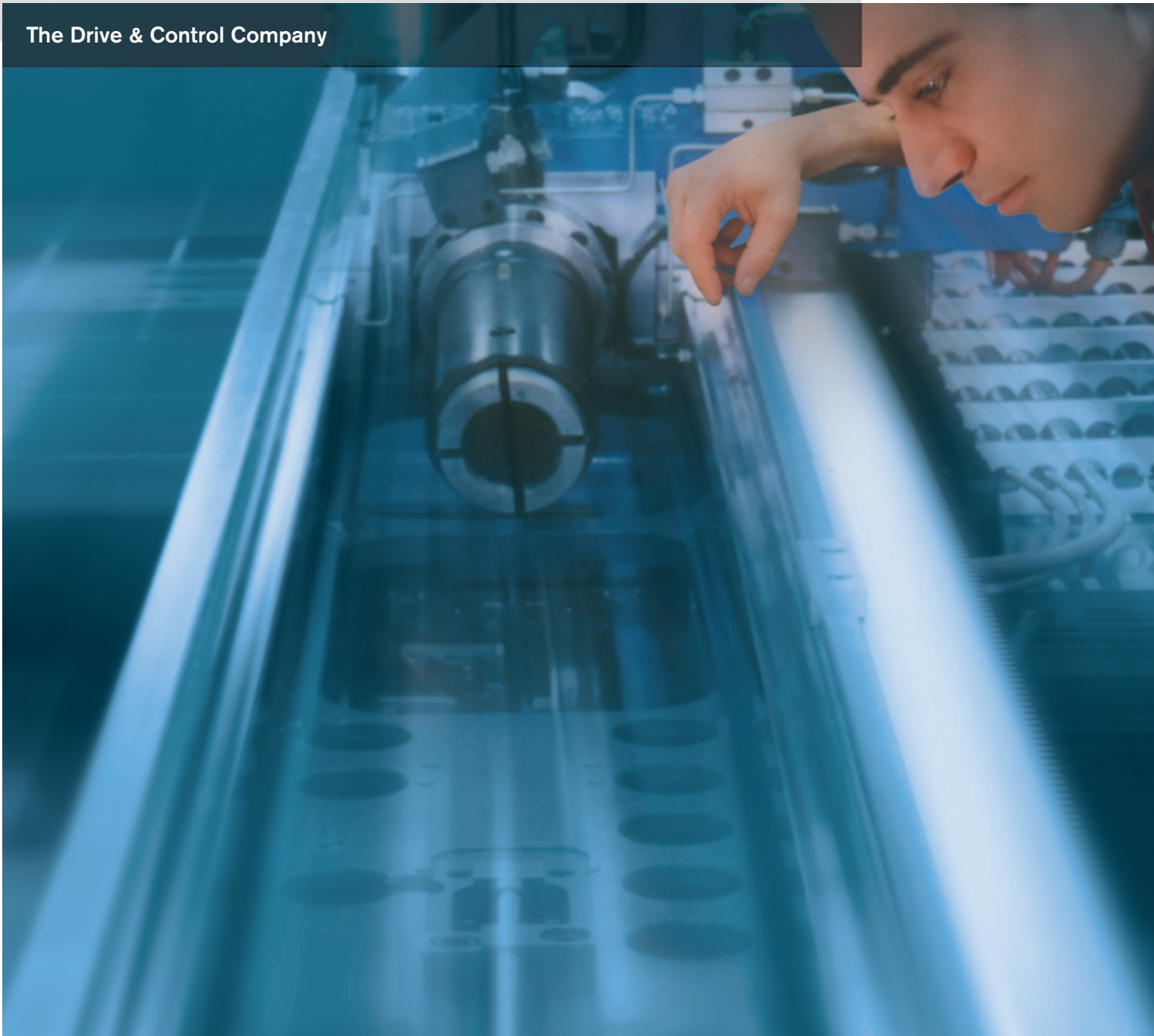

Contents		Page
	How the program works	3
	Linear Bushings	4
	Linear Bushings Technical Information	5
	Ball Rail Systems	6
	Runner Block Technical Information	7
	Rail Technical Information	8
	Miniature Ball Rail Systems	9
	Miniature Runner Block Technical Information	10
	Miniature Rail Technical Information	11
	Ball Screws	12
	Miniature Ball Screws	13
	Customer Service	14
	Your Drive & Control Company	15

# GreenLight™ Next Day Shipments

When your project won't wait, rely on Rexroth for a GreenLight start, every time.



In today's fast-paced manufacturing environment, you need quality linear motion components in the right size and length and you need them **FAST!**

With world-class quality, and the sizes and lengths you want. Our GreenLight Program assures next day shipping of the industry's most commonly used linear motion components, so you can move your design quickly from concept, to prototyping, to production.

## Thoughtful Details Mean Better Performance

Rexroth linear motion components are designed to provide the smoothest performance and longest life possible, to enhance machine performance and give our customers the edge they need to compete successfully. World-class precision machining, for example, lets you put any runner block on any rail of the same size including our miniature sizes.

This means that you can easily upgrade later without having to unbolt and replace an entire assembly.

Thoughtful details like these characterize our entire product offering. Profiled rail products feature Rail Seal™ cover strips for smooth performance and long service life, retained ball and roller technology for smooth operation, and even integrated measuring for applications requiring the most advanced technology.

Custom end machining on ball screws and shafts, pre-loaded single and double nut designs with integral sealing, self-aligning inch and metric bushings. It all adds up to the highest-quality, broadest line of linear motion components from any supplier. And it's all available fast, to give you a GreenLight start on every project.

### Here's how it works:

Send us your order by 3:00 p.m. for products included in the program, and we'll ship them by the end of the following business day. That's all there is to it. Please note that for certain products, quantities may be limited.

*Emergency service is also available.*

# Rexroth Linear Bushings and Shafts, GreenLight Selection



Bosch Rexroth is the global leader in metric bushings. Whether you need standard bushings or cut-to-length linear shafts, our products are available in both inch and metric sizes.

Offered in a wide range of standard bearing housings, mountings, seals, shaft supports, and end finishes, our products can be interchanged with those of other major manufacturers.

## Linear Bushings: Technical Data and Ordering Information

### Metric Bushings: Closed

Size(mm)	STD Precision with 2 seals	SUPER A with 2 seals	COMPACT with 2 seals
5	0602-305-10	-	-
8	0602-308-10	-	-
12	0602-012-10	0670-212-40	0658-212-40
16	0602-016-10	0670-216-40	0658-216-40
20	0602-020-10	0670-220-40	0658-220-40
25	0602-025-10	0670-225-40	0658-225-40
30	0602-030-10	0670-230-40	0658-230-40
40	0602-040-10	0670-240-40	0658-240-40
50	0602-050-10	0670-250-40	0658-250-40

### Metric Shafts: Carbon Steel

Size (mm)	AISI 1060 Tolerance h6
5	1000-005-00
8	1000-008-00
12	1000-012-00
16	1000-016-00
20	1000-020-00
25	1000-025-00
30	1000-030-00
40	1000-040-00
50	1000-050-00

### Inch Bushings: Closed

Size(in)	STD Precision with 2 seals	SUPER with 2 seals
0.250	0750-204-00	0755-204-00
0.375	0750-206-00	0755-206-00
0.500	0750-208-00	0755-208-00
0.625	0750-210-00	0755-210-00
0.750	0750-212-00	0755-212-00
1.000	0750-216-00	0755-216-00
1.250	0750-220-00	0755-220-00
1.500	0750-224-00	0755-224-00
2.000	0750-232-00	0755-232-00

### Inch Shafts: Carbon Steel

Size (in)	AISI 1060 Class L
0.250	1700-004-08
0.375	1700-006-08
0.500	1700-008-08
0.625	1700-010-08
0.750	1700-012-08
1.000	1700-016-08
1.250	1700-020-08
1.500	1700-024-08
2.000	1700-032-08

## Need more than what you see here?

For information on the complete line of Rexroth bushing products, request catalog RA 99 110 for inch and

RA 83 100 for metric or download it from the Linear Motion and Assembly Technologies area at:  
[www.boschrexroth-us.com](http://www.boschrexroth-us.com).

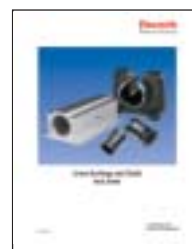

## Linear Bushing Dimensions Closed Type

Dimensions: Metric Bushings (mm) Standard and Super Series

Bore / d	D h5	C h12	C <sub>1</sub> H13	C <sub>2</sub>	D <sub>1</sub>	
					Standard	Super
5 <sup>1)</sup>	12	22	14.2	1.1	11.1	-
8 <sup>1)</sup>	16	25	16.2	1.1	14.7	-
10	19	29	21.6	1.3	-	18
12	22	32	22.6	1.3	20.5	21
16	26	36	24.6	1.3	24.9	24.9
20	32	45	31.2	1.6	30.5	30.5
25	40	58	43.7	1.85	38.5	38.5
30	47	68	51.7	1.85	44.5	44.5
40	62	80	60.3	2.15	58	58.5
50	75	100	77.3	2.65	71	71.5

Dimensions: Metric Bushings (mm)  
Compact Series

Bore / d	D	C ± 0.2
12	19	28
16	24	30
20	28	30
25	35	40
30	40	50
40	52	60
50	62	70

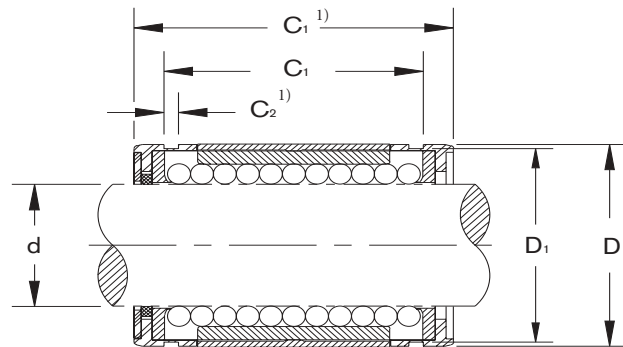

<sup>1)</sup> C<sub>1</sub>, C<sub>2</sub> and D<sub>1</sub> refer to the snap ring groove.

There is no snap ring groove on the metric compact type.

The outer dimension of the metal stamping is slightly oversized.  
No special retention elements are necessary.

For load capacities and life prediction see Bosch Rexroth catalog RE83100 for metric linear bushings and RA99110 for inch products.

Dimensions: Inch Bushings (in) Standard and Super Series

Bore / d	D	C	C <sub>1</sub>		C <sub>2</sub>	D <sub>1</sub>
			Standard	Super		
.2500/.2496	0.5000	0.7500	0.5110	0.0390	0.4687	0.4687
.3750/.3746	0.6250	0.8750	0.6385	0.0390	0.5880	0.5880
.5000/.4996	0.8750	1.2500	0.9625	0.0459	0.8209	0.8209
.6250/.6246	1.1250	1.5000	1.1039	0.0559	1.0590	1.0590
.7500/.7496	1.2500	1.6250	1.1657	0.0559	1.1760	1.1760
1.0000/.9996	1.5625	2.2500	1.7547	0.0679	1.4687	1.4687
1.2500/1.2495	2.0000	2.6250	2.0047	0.0679	1.8859	1.8859
1.5000/1.4995	2.3750	3.0000	2.4118	0.0859	2.2389	2.2389
2.0000/1.9995	3.0000	4.0000	3.1917	0.1029	2.8379	2.8379

## Rexroth Ball Rail Systems Greenlight Program



Rexroth Ball Rail® Systems in the GreenLight™ program are available in all standard sizes 15-45, N accuracy, with standard and slimline runner blocks in clearance and 2% preload versions. Rails are cut to length, in 1 mm increments.

Rexroth Ball Rail® Systems feature major product advances and virtually eliminate maintenance.

Since all Rexroth runner blocks are dimensionally compatible with any rail of the same size, the fast delivery in our GreenLight program means lower spare parts inventory with no limited selection of rail lengths, and no need to replace the block and rail together as a matched set.

To assure your Ball Rail System can be shipped on the following day, please limit the quantities to 10 rails and 20 runner blocks.

To order Runner Blocks, simply pick the sizes and styles that suit your application (see page 5 for dimensions and load data), and choose the part numbers from the table at right. For miniature sizes, see page 7. For Rails, see page 6.



Standard



Slimline

### Runner Block Part Numbers

Size	Preload Type*	Accuracy Class	Standard	Slimline
15	CLR	N	1651-194-20	1622-194-20
	.02C		1651-114-20	1622-114-20
20	CLR	N	1651-894-20	1622-894-20
	.02C		1651-814-20	1622-814-20
25	CLR	N	1651-294-20	1622-294-20
	.02C		1651-214-20	1622-214-20
30	CLR	N	1651-794-20	1622-794-20
	.02C		1651-714-20	1622-714-20
35	CLR	N	1651-394-20	1622-394-20
	.02C		1651-314-20	1622-314-20
45	CLR	N	1651-494-10	1622-494-10
	.02C		1651-414-10	1622-414-10

\* CLR = up to 10µm clearance  
 .02C = 2% of dynamic capacity, C

### Need more than what you see here?

For information on the complete line of Rexroth Ball Rail® Systems products, request catalog **RA 82 202** or download it from the Linear Motion and Assembly Technologies area at [www.boschrexroth-us.com](http://www.boschrexroth-us.com).



# 1651 Runner Blocks: Technical Data

(For rail information, see page 8)

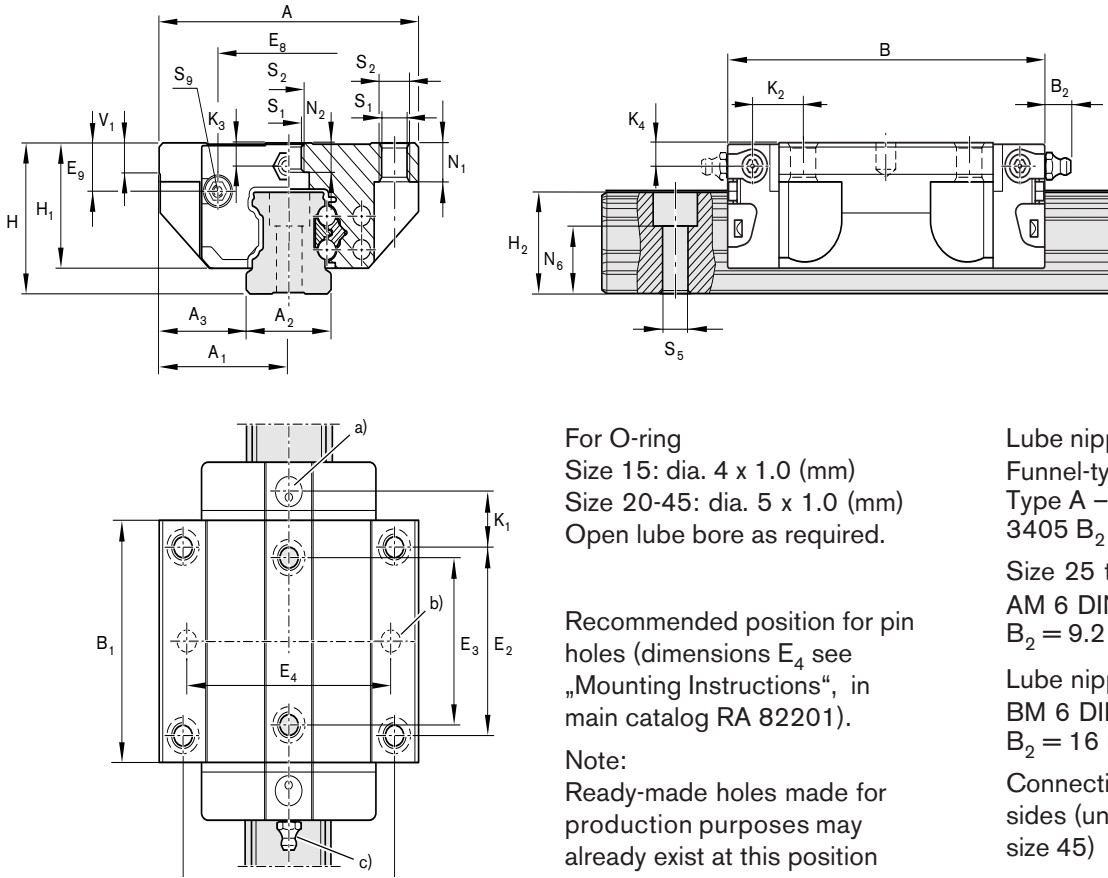

For O-ring  
Size 15: dia. 4 x 1.0 (mm)  
Size 20-45: dia. 5 x 1.0 (mm)  
Open lube bore as required.

Recommended position for pin holes (dimensions  $E_4$  see „Mounting Instructions“, in main catalog RA 82201).

Note:  
Ready-made holes made for production purposes may already exist at this position

Lube nipple Size 15 and 20:  
Funnel-type nipple  
Type A – Thread size M3 DIN 3405  $B_2 = 1.6$  mm

Size 25 to 45:  
AM 6 DIN 71412  
 $B_2 = 9.2$  mm

Lube nipple Size 45  
BM 6 DIN 71412  
 $B_2 = 16$  mm

Connection possible on all sides (under preparation for size 45)

Fig. 1: Runner Block Dimensions

Size	Dimensions (mm)																		
	A	A <sub>1</sub>	A <sub>2</sub>	A <sub>3</sub>	B	B <sub>1</sub>	H	H <sub>1</sub>	H <sub>2</sub>	V <sub>1</sub>	E <sub>1</sub>	E <sub>2</sub>	E <sub>3</sub>	E <sub>8</sub>	E <sub>9</sub>	K <sub>1</sub>	K <sub>2</sub>	K <sub>3</sub>	K <sub>4</sub>
15	47	23.5	15	16.0	58.2	39.2	24	19.90	16.20	5.0	38	30	26	24.55	6.7	8.00	9.6	3.20	3.20
20	63	31.5	20	21.5	75.0	49.6	30	25.35	20.55	6.0	53	40	35	32.50	7.3	11.80	11.8	3.35	3.35
25	70	35.0	23	23.5	85.6	57.8	36	29.90	24.25	7.5	57	45	40	38.30	11.5	12.45	13.6	5.50	5.50
30	90	45.0	28	31.0	97.2	67.4	42	35.35	28.35	7.0	72	52	44	48.40	14.6	14.00	15.7	6.05	6.05
35	100	50.0	34	33.0	110.0	77.0	48	40.40	31.85	8.0	82	62	52	58.00	17.35	14.50	16.0	6.90	6.90
45	120	60.0	45	37.5	133.0	97.0	60	50.00	39.85	10	100	80	60	69.80	20.90				

Size	Dimensions (mm)								Mass (kg)	Load capacities (N)		Moments (Nm)			
	N <sub>1</sub>	N <sub>2</sub>	N <sub>6</sub> <sup>±0.5</sup>	S <sub>1</sub>	S <sub>2</sub>	S <sub>5</sub>	S <sub>9</sub>	C dyn.		C <sub>0</sub> stat.	M <sub>t</sub> dyn.	M <sub>t0</sub> stat.	M <sub>L</sub> dyn.	M <sub>L0</sub> stat.	
15	5.2	4.4	10.65	4.3	M5	4.4	M2.5-3.5deep	0.20	7 800	13 500	74	130	40	71	
20	7.7	5.2	13.55	5.3	M6	6.0	M3-5deep	0.60	18 800	24 400	240	310	130	165	
25	9.3	7.0	15.55	6.7	M8	7.0	M3-5deep	0.80	22 800	30 400	320	430	180	240	
30	11.0	7.9	17.35	8.5	M10	9.0	M3-5deep	1.20	31 700	41 300	540	720	290	380	
35	12.0	10.2	20.85	8.5	M10	9.0	M3-5deep	1.75	41 900	54 000	890	1160	440	565	
45	15.0	12.4	23.50	10.5	M12	14	M4-7deep	2.90	68 100	85 700	1830	2310	890	1130	

# Rails: Technical Data and Ordering Information



## Rail Part Numbers

Size	Accuracy Class	Part Number
15	N	1605-104-31....
20	N	1605-804-31....
25	N	1605-204-31....
30	N	1605-704-31....
35	N	1605-304-31....
45	N	1605-404-31....

## Ordering guide rails

### Example part number:

**1605-304-31, 1756**

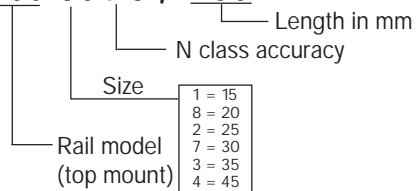

Guide rail size 35,  
 accuracy class N,  
 rail length 1756 mm,

When ordering non-standard rails, you will also need to specify mounting hole locations. Fig. 3 provides hole spacing information. Make sure that the hole spacing matches up with the overall length of your rail.

$$L = (n_T \times T) + (2 \times T_1)$$

where L = length

nT = number of spaces, T

T = hole spacing

T<sub>1</sub> = distance to first hole

For ordering examples when ordering intermediate lengths, please consult the main Ball Rail catalog, page 83.

Fig. 2: Rail Dimensions

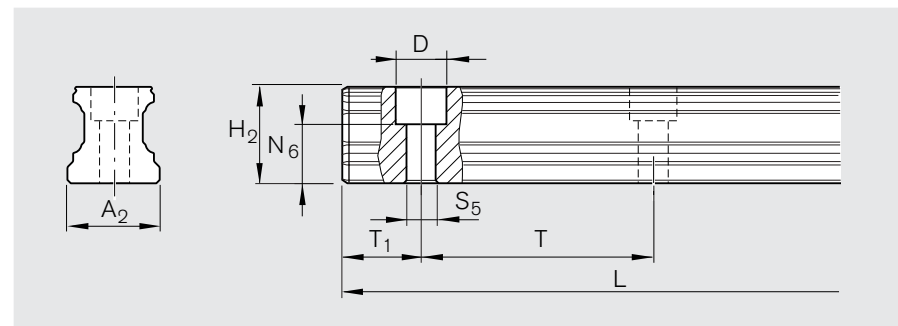

## Dimensions

Size	A <sub>2</sub>	H <sub>2</sub>	N <sub>6</sub>	D	S <sub>5</sub>	T <sub>1S</sub>	T <sub>1 min</sub>	T	L <sub>ma</sub>	Mass kg/m
15	15	16.20	10.3	7.4	4.4	28.0	10	60	3000	1.4
20	20	20.55	13.2	9.4	6.0	28.0	10	60	4000	2.4
25	23	24.25	15.2	11.0	7.0	28.0	10	60	4000	3.2
30	28	28.35	17.0	15.0	9.0	38.0	12	80	4000	5.0
35	34	31.85	20.5	15.0	9.0	38.0	12	80	4000	6.8
45	45	39.85	23.5	20.0	14.0	50.5	16	105	4000	10.5

Fig. 3: Hole Dimensions

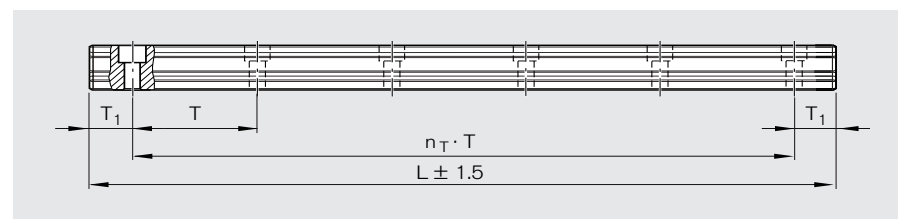

# Rexroth Miniature Ball Rail Systems, GreenLight Selection



Rexroth Miniature Ball Rail® Systems in the GreenLight™ program are available in all standard sizes: 7, 9M3, (9M2 also available) 12 and 15, accuracy class H in clearance and preload versions. All feature low friction seals and are pre-lubricated. Precision-machined, corrosion resistant steel rails are cut to length, in 1 mm increments.

Like their standard-sized counterparts, all Rexroth miniature runner blocks can fit on any rail of the same size.

The fast delivery of our GreenLight Program means lower spare parts inventory with no limited selection of rail lengths, and no need to replace the block and rail together as a matched set.

To assure your Rexroth Miniature Ball Rail System can be shipped on the following day, please limit the quantities to 10 rails and 20 runner blocks.

## Runner Blocks: Technical Data and Ordering Information

To order Runner Blocks, simply pick the sizes that suit your application (see page 8 for dimensions and load data), and choose the part numbers from the table at right. For standard sizes in the GreenLight program, see page 4. For Miniature Rails, see page 9.

### Runner Block Part Numbers

(see page 8 for dimensions and specifications.)

Size	Preload Type	Accuracy Class	Standard
7	CLR	H	0442-793-01
	Preload		0442-713-01
9/M3	CLR	H	0442-893-01
	Preload		0442-813-01
12	CLR	H	0442-293-01
	Preload		0442-213-01
15	CLR	H	0442-593-01
	Preload		0442-513-01

### Need more than what you see here?

For information on the complete line of Rexroth miniature products, request catalog RA 82 210 or download it from the Linear Motion and Assembly Technologies area at [www.boschrexroth-us.com](http://www.boschrexroth-us.com).



## Miniature Runner Blocks: Technical Data

Fig. 4: Runner Block Dimensions

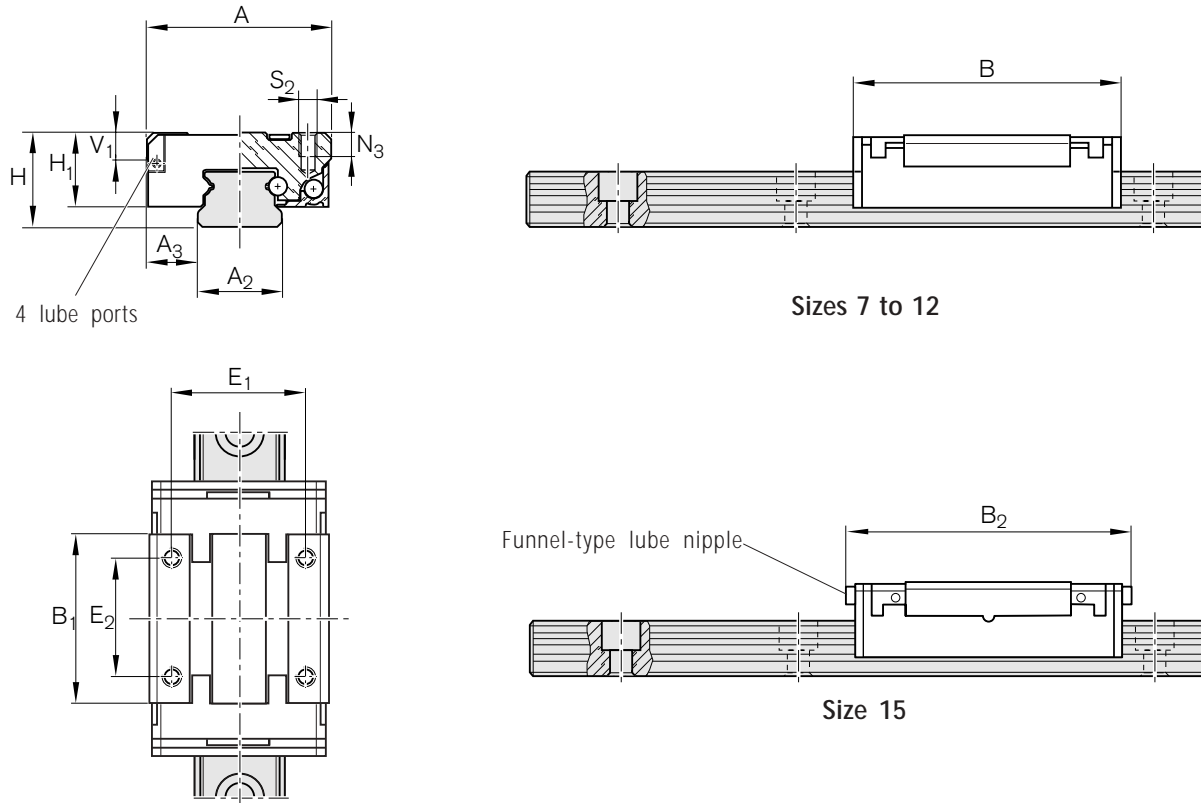

Size	Dimensions (mm)												
	A	A <sub>2</sub>	A <sub>3</sub>	B	B <sub>1</sub>	B <sub>2</sub>	H	H <sub>1</sub>	V <sub>1</sub>	E <sub>1</sub>	E <sub>2</sub>	N <sub>3</sub>	S <sub>2</sub>
7	17	7	5.0	24.0	14.5	–	8	6.5	2.0	12	8	2.5	M2
9/M3	20	9	5.5	31.0	20.7	–	10	8.0	2.8	15	10	3.5	M3
12	27	12	7.5	34.8	21.6	–	13	10.0	3.3	20	15	3.5	M3
15	32	15	8.5	43.0	27.2	46	16	12.0	4.7	25	20	4.0	M3

Size	Weight Runner blocks (g)	Load capacities (N)		Moments (Nm)			
		C	C <sub>0</sub>	M <sub>t</sub>	M <sub>t0</sub>	M <sub>L</sub>	M <sub>L0</sub>
		dyn.	stat.	dyn.	stat.	dyn.	stat.
7	9	860	1400	3.1	5.1	1.9	3.2
9/M3	16	1180	2100	5.4	9.6	3.6	6.4
12	33	2310	3470	13.7	20.6	7.9	11.8
15	47	4200	6260	31.2	46.3	18.3	27.0

# Miniature Rails: Technical Data and Ordering Information



## Rails

Size	Accuracy Class	Part Number
7	H	0445-703-31....
9M3	H	0445-803-31....
12	H	0445-203-31....
15	H	0445-503-31....

Fig. 5: Rail Dimensions

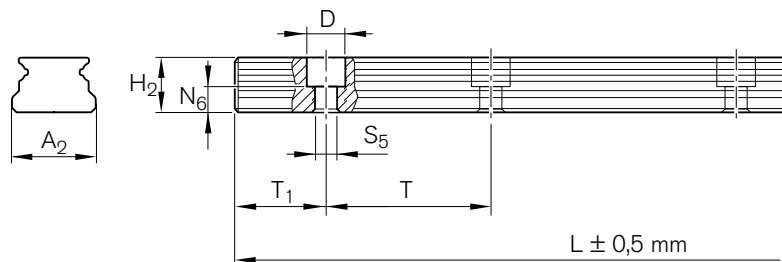

## Ordering guide rails

Example part number:

**0445-203-31, 771**

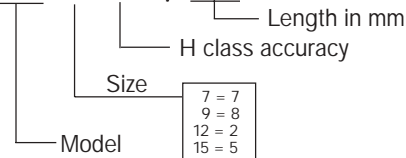

Guide rail size, accuracy class H, preferred rail length 771 mm (standard rail)

If no  $T_1$  is specified by the customer, both ends of the guide rail will be identical. The rail lengths were calculated using the formula for recommended rail lengths. For more information, please see our Miniature Ball Rail catalog RA82201.

When ordering non-standard rails, you will also need to specify mounting hole locations.

Fig. 5 provides hole spacing information for  $T_1$  and  $T$ . Make sure that the hole spacing matches up with the overall length of your rail.

Guide rail:

Position tolerance of the mounting holes for

- rail length up to 500 mm  $\oplus \ominus \varnothing 0.3$

- rail length up to 1000 mm  $\oplus \ominus \varnothing$  up to 0.6, increasing in linear proportion

## Dimensions

Size	$A_2$	$H_2$	$N_6$	D	$S_5$	$T_{1 \min}$	T	$L_{\max}$	Weight g/100 mm
7	7	4.7	2.2	4.3	2.5	2.5	15	1000	22
9/M3	9	5.5	2.2	6.0	3.5	3.5	20	1000	33
12	12	7.8	3.0	6.0	3.5	3.5	25	1000	61
15	15	9.5	4.7	6.0	3.5	4.5	40	1000	97

## Rexroth Ball Screws, GreenLight Selection



The Bosch Rexroth GreenLight™ program assures next-day shipment of pre-machined Ball Screw assemblies. All Rexroth Ball Screws are precision-rolled, finished and polished, and cut to the lengths indicated in the table below. A single nut with V-thread connection is pre-mounted, and the screw is supplied pre-machined according to our standard fixed-free end bearing specifications (see fig. 7).

The ball nut is mounted with the V-thread connector toward the fixed bearing end and pre-lubricated.

End bearings are also available from stock. Please inquire.

To assure your Ball Screw assemblies can be shipped on the following day, please limit the quantity to 10 assemblies.

### Ball Screw Assemblies: Technical Data and Ordering Information

- Without Seals
- With Backlash
- T10 Screw Material

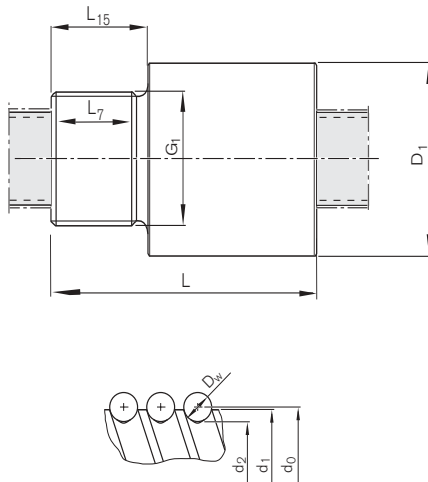

Fig. 6: Ball Nut Dimensions

#### Ball Screw Assembly Part Numbers

Diameter (mm)	Lead (mm)	Overall Length (mm)	Ball Nut Type	Part Number
12	5 RH	400	ZEV-E-S	1530-4-0890
12	10 RH	400	ZEV-E-S	1530-4-1014
16	5 RH	550	ZEV-E-S	1510-0-3092
16	5 LH	550	ZEV-E-S	1550-0-3174
16	10 RH	550	ZEV-E-S	1510-0-3404
20	5 RH	550	ZEV-E-S	1510-1-3103

#### Ball Nut Dimensions (mm)

Size	d <sub>1</sub>	d <sub>2</sub>	D <sub>1</sub>	G <sub>1</sub>	L <sub>5/10</sub>	L <sub>7</sub>	L <sub>15</sub>	Backlash
12	11.4	9.9	25.5	M20x1	36/40	8.5	10	1.0
16	15.0	12.9	32.5	M26x1.5	40/54	10.5	12	1.0
20	19.0	16.9	38	M35x1.5	50	12.5	14	1.0

#### Machining Dimensions (mm)

Size	L	D <sub>1</sub>	DT1	L <sub>1</sub>	D <sub>2</sub>	DT2	L <sub>2</sub>	G <sub>1</sub>	LG <sub>1</sub>
12	40	6	H8	14	5	H8	16	M6x0.5	10
16	50	10	H8	18	8	H8	20	M10x1	12
20	60	12	H8	23	10	H8	25	M12x1	12

Fig. 7: Machining Dimensions

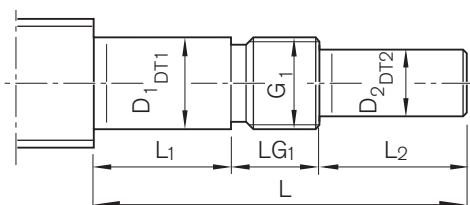

# Rexroth Miniature Ball Screws, GreenLight Selection



The Bosch Rexroth GreenLight™ program assures next-day shipment of pre-machined Miniature Ball Screw assemblies.

End bearings are also available from stock. Please inquire.

All Rexroth Ball Screws are precision-rolled, finished, polished and machined to the specifications in Figure 9 below. A single ball nut is pre-lubricated and pre-mounted, with the flange toward the machined end.

To assure your Miniature Ball Screw assemblies can be shipped the following day, please limit quantities to 10 assemblies.

## Miniature Ball Screw Assemblies: Technical Data and Ordering Information

- Reduced Backlash (0-.005m)
- T7 Screw Material

### Miniature Ball Screw Assembly Part Numbers

Diameter (mm)	Lead (mm)	Overall Length (mm)	Ball Nut Type	Part Number
6	1	255	FEM-E-B	1530-1-0008
6	2	255	FEM-E-B	1530-1-0009
8	1	355	FEM-E-B	1530-2-0562
8	2	355	FEM-E-B	1530-2-0563

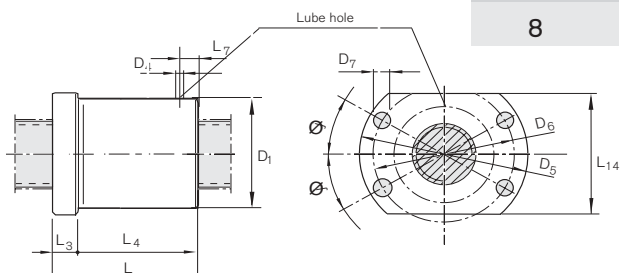
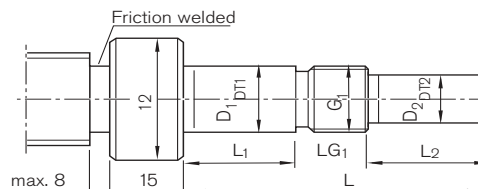

Fig. 8: Ball Nut Dimensions

### Ball Nut Dimensions (mm)

Size	d <sub>2</sub>	D <sub>1</sub>	D <sub>4</sub>	D <sub>5</sub>	D <sub>6</sub>	D <sub>7</sub>	L	L <sub>3</sub>	L <sub>4</sub>	L <sub>7</sub>	L <sub>14</sub>	Ø
6	5.3	12	2	24	18	3.4	19.5	3.5	16	3.5	16	30
6	5.3	12	2	24	18	3.4	22.5	3.5	19	3	16	30
8	7.3	16	2	28	22	3.4	22	6	16	3.5	19	30
8	7.0	16	2	28	22	3.4	25	6	19	3	19	30

Fig. 9: Machining Dimensions



### Machining Dimensions (mm)

L	D <sub>1</sub>	DT1	L <sub>1</sub>	D <sub>2</sub>	DT2	L <sub>2</sub>	G <sub>1</sub>	LG <sub>1</sub>
40	6	H6	14	5	H7	16	M6x0.5	10

Machining is common for all GreenLight miniature assemblies

## Fast, local support from a global company, 24 hours a day.

**On-call service, 24-hour access via the Web—everything you need before, during, and after your installation—from the industry experts.**



Most manufacturing facilities operate 24 hours a day. Downtime and waiting for service are natural enemies of the fast-paced world of production and assembly...and will ultimately erode your profits.

That's why Bosch Rexroth has a commitment to your productivity that extends well beyond providing you with high-quality, best-in-class products. We want to be sure that you have access to our unsurpassed customer support network anytime, anywhere.

From our skilled customer service team to our on-site service experts, we have the support you'll need before you purchase our products until well after they're working hard in your plant. We provide:

- On-call services, when you need them
- Extensive parts inventory
- Experienced application engineering
- 24-hour Web access
- Comprehensive training at your site or ours
- Cost-effective preventive maintenance programs
- Detailed, easy-to-use manuals, in various languages
- Complete collection of CAD files and electronic literature (available on CD or downloadable)

Your challenging manufacturing situations deserve local attention when you need it. Even if you operate in several countries, we're there—our support network spans the globe and is available wherever you are.

**Call us today at 1-800-438-5983**

**Detailed, easy-to-use catalogs, manuals, and training materials**



**Time-saving design software and online ordering**



**On-site support for your challenging manufacturing situations**





**Your business.  
Your Drive & Control Company.**

Bosch Rexroth, the Drive & Control Company is a global supplier of drive, control, and motion products to companies in 80 countries around the world. A wholly-owned subsidiary of Robert Bosch GmbH (Germany), Bosch Rexroth has a strong presence in the United States, where we employ around 2,000 people.

Bosch Rexroth is a global supplier offering high-quality products, modules, systems, and services for hydraulic, electric, pneumatic, and mechanical drive and control technology for factory automation

and mobile applications. With our six divisions, we serve almost every industry, including automotive, machine tool, packaging, printing, electronic assembly, semiconductor, and material handling.

This diverse combination of competencies allows us to offer our customers more than the world class products we are known for—we also give you superior application knowledge on which you can build complete systems and solutions no matter what the application is.

We offer our customers applications engineering expertise and have in-depth knowledge of their industry and their machine.

Because of our broad line of best-in-class products, we offer single-source accountability across all the drive and control technologies. And, because of our world-class capabilities in mechanics, hydraulics, pneumatics, electrical and electronic engineering, no one is better positioned for the convergence of technologies like mechatronics and fluidronics. So, when it comes to helping you build sustainable competitive advantage, there is simply no contest.

Headquartered in Hoffman Estates, IL, just outside of Chicago, Bosch Rexroth has six regional centers/sales offices, nine manufacturing and assembly facilities, and several applications and R&D centers located across the United States.

And with our broad global network of distributors, we can still offer you local sales and service whenever you need it.

Bosch Rexroth Corporation  
Linear Motion and  
Assembly Technologies  
14001 South Lakes Drive  
Charlotte, NC 28273  
Phone: 800-438-5983  
Fax: 704-583-0523  
info.chr@boschrexroth-us.com  
www.boschrexroth-us.com

Bosch Rexroth Corporation  
5150 Prairie Stone Parkway  
Hoffman Estates, IL 60192-3707  
Phone: 847-645-3600  
Fax: 847-645-0811

Bosch Rexroth Corporation  
Industrial Hydraulics  
2315 City Line Road  
Bethlehem, PA 18017-2131  
Phone: 610-694-8300  
Fax: 610-694-8467

Bosch Rexroth Corporation  
Electric Drives and Controls  
5150 Prairie Stone Parkway  
Hoffman Estates, IL 60192-3707  
Phone: 847-645-3600  
Fax: 847-645-6201

Bosch Rexroth Corporation  
Pneumatics  
1953 Mercer Road  
Lexington, KY 40511-1021  
Phone: 859-254-8031  
Fax: 859-281-3483

Bosch Rexroth Corporation  
Mobile Hydraulics  
P.O. Box 394  
1700 Old Mansfield Road  
Wooster, OH 44692-0394  
Phone: 330-263-3300  
Fax: 330-263-3333