

Suspension system CS-600 NR



Product description

The CS-600 NR suspension system has been developed specifically for suspending control enclosures in hygiene environments in the food and pharmaceutical industry. Compared with suspension products, hitherto familiar, this system is distinguished by its particular suitability for hygiene environments and its fully modular design. The CS-600 NR enables the user to configure angled systems without the need for pre-formed tubing. This dispenses with the time-consuming process of procuring specially pre-formed tubing. The modular suspension system is flexible and versatile, and can be assembled with ease by the user from components that are available ex stock.

System benefits

- Assembly apertures on bearing components with horizontal socket
- No external screws or dirt traps - ideal to clean
- Tubing simply clamped in position
- Anti-vibration capability for all components
- Loading capacity 600 N/m
- IP 66 protection rating
- Factory-set torque
- Modern design
- Wide choice of components for a particularly large number of combination options
- Choice of materials for components
Stainless steel X10 CrNiS18 9 or anodised aluminium

Cable entry

The various suspension system components offer differing amounts of space through which to insert cables. The diagrams below show the dimensions at the narrowest point of apertures inside the components.

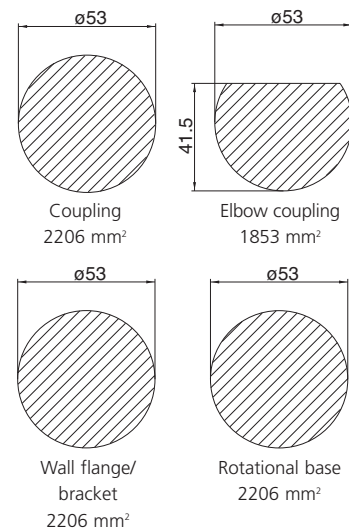

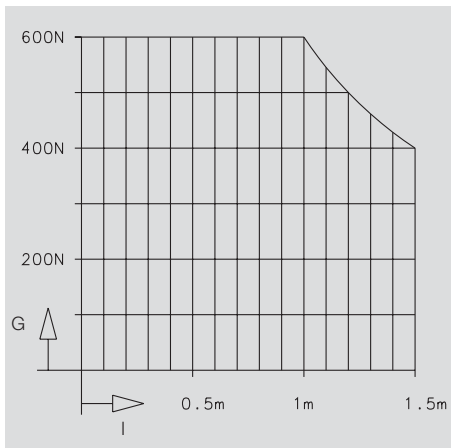

Load diagram

The loading capacity of the CS-600 NR suspension system product line is shown in the diagram.

In the following description, system length I refers to the length shown in the diagram.

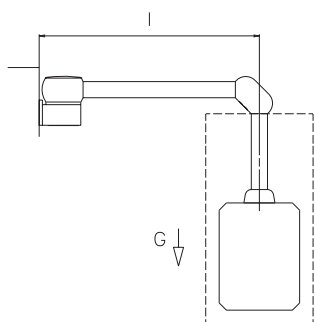

Selection support for different load capacities are presented on pages 400/401.

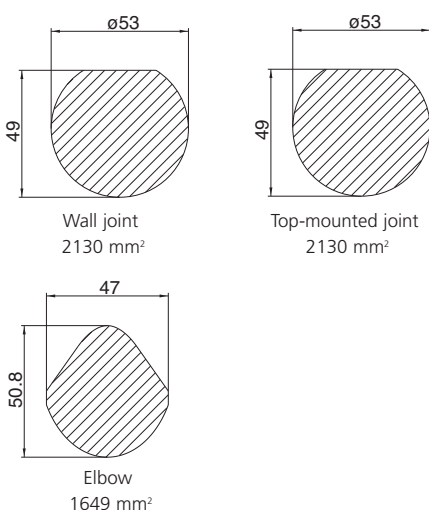

Materials and surfaces

Stainless steel tubings	1.4301
Aluminium components	AlMgSi 1
Stainless steel components	1.4305
Bearings	POM
O rings	NBR

System combinations

The wide range of components permits a high level of flexibility in configuring suspension systems. A selection of possible combinations is shown here.

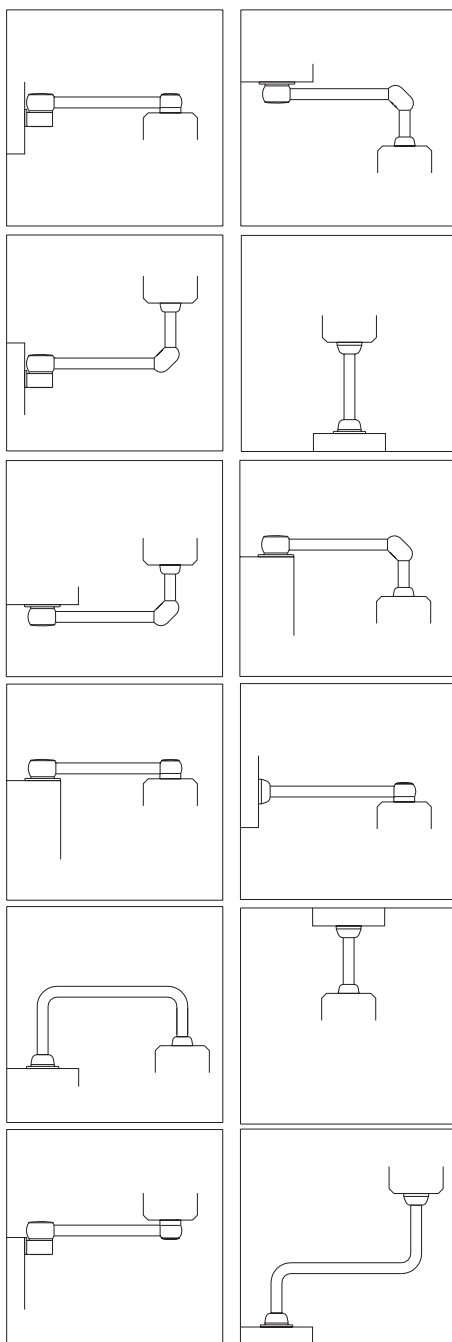

Machining enclosures for mounting couplings

The coupling hole geometries for enclosure machining are shown in the diagram below.

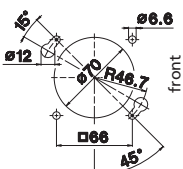

Tubings

The 60.3 mm outer diameter tubes are made from 3.6 mm gauge stainless steel and are available in the following standard sizes.

250 mm	Part. number 952.3.0010.00
500 mm	Part. number 952.3.0020.00
750 mm	Part. number 952.3.0030.00
1000 mm	Part. number 952.3.0040.00
1250 mm	Part. number 952.3.0050.00
1500 mm	Part. number 952.3.0060.00

Customised tubings

On request, pre-formed tubings are available in different variants for BERNSTEIN's CS-600 NR suspension system. The three different variants are L-shaped, U-shaped and Z-shaped. Straight tubings can also be supplied in customer-specific lengths. To order customised tubings, simple indicate the shape you require when ordering (e.g. straight, L, U or Z-shaped) together with dimensions. The letters used to denote the various dimensions are shown in the drawings below.

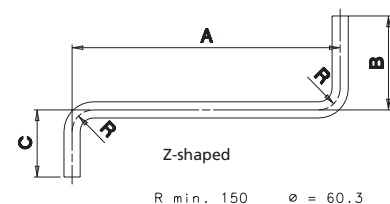
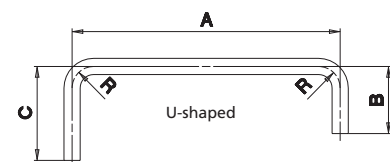
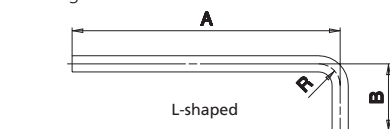

Note: Dimensions B and C at least 300 mm; dimension A in U and Z-shaped version at least 450 mm.

System components

Type CS-600 NR



For enclosure mounting



For enclosure mounting

Article
Part number Stainless steel

Coupling
101.4.0501.00

Elbow coupling
101.4.0502.00

Example application

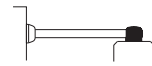
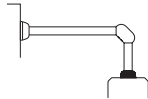

Version
 Flange coupling for attaching enclosures. Turns through 300° with rotation limiter. Pre-set torque. Maintenance-free bearings. Complete with gaskets and fixing material.

Version
 Flange elbow coupling for attaching enclosures. Assembly aperture cover conceals screws for perfect hygiene. Turns through 300° with rotation limiter. Pre-set torque. Maintenance-free bearings. Complete with gaskets and fixing material.

Drawings

(dimensions in mm)

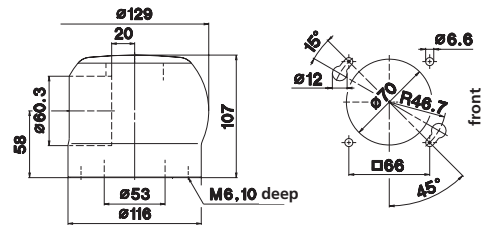
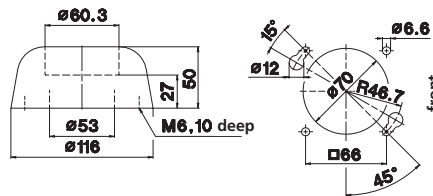

Article
Part number Stainless steel

Elbow
101.4.0507.00

Rotational base, attachment from outside
101.4.0504.00

Example application

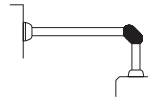

Version
 Elbow for connecting two tubes at 90°. Includes screw cover and gaskets.

Version
 Rotational base for attachment to machine or floor. Turns through 300° with rotation limiter. Pre-set torque. Maintenance-free bearings. Complete with gaskets.

Drawings

(dimensions in mm)

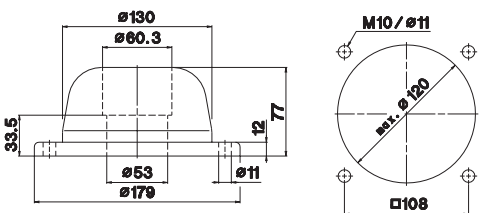
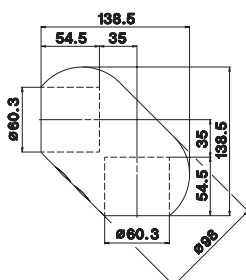

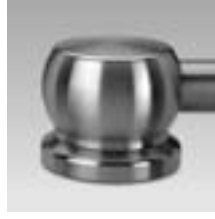

Rotational base, attachment from inside
101.4.0515.00

Top-mounted joint, attachment from inside
101.4.0516.00

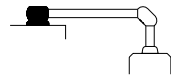

Rotational base for attachment to machine or floor. Turns through 300° with rotation limiter. Pre-set torque. Maintenance-free bearings. Complete with gaskets.

Top-mounted joint for attachment to horizontal surfaces. Assembly aperture cover conceals screws for perfect hygiene. Turns through 300° with rotation limiter. Pre-set torque. Maintenance-free bearings. Complete with gaskets.

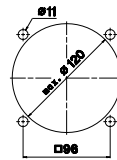
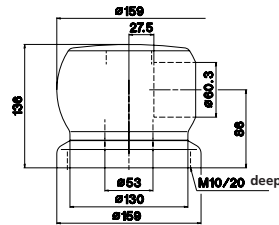
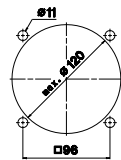
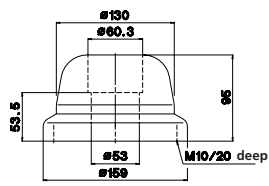

Wall flange/base bracket
101.4.0503.00

Top-mounted, attachment from outside
101.4.0506.00

Wall joint
101.4.0505.00

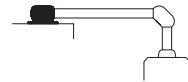
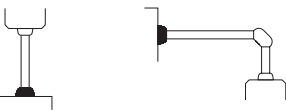

Wall flange or base bracket for attachment to horizontal and vertical surfaces. Complete with gaskets.

Top-mounted joint for attachment to horizontal surfaces. Assembly aperture cover conceals screws for perfect hygiene. Turns through 300° with rotation limiter. Pre-set torque. Maintenance-free bearings. Complete with gaskets.

Wall joint for attachment to vertical surfaces. Assembly aperture cover conceals screws for perfect hygiene. Turns through 300° with rotation limiter. Pre-set torque. Maintenance-free bearings. Complete with gaskets.

